



# USD 261 Service Center

1745 W. Grand  
Haysville, KS 67060

Phone: 316-554-2210 • Fax 316-554-2212  
bknudson@usd261.com

B.J. Knudson  
Executive Director of  
Operations

Memo:

TO: Haysville Board of Education

FR: B.J. Knudson, Executive Director of Operations

DA:

RE: k V 7 #

We are asking for a resolution authorizing Haysville USD 261 to enter into contract # U @ for the 7 # V . The project will take place over the summer so it will not disrupt the learning environment. The cost of the project (\$46,000) will be paid out of 7 O Funds. We sent the request for proposal to different vendors. We received 3 bid sheets back. The bid results are as follows:

# U	\$
k	\$ 3,
Myo-	\$
# U ‡	No bid and has not returned any calls
7	V
k # U	V



1655 Wabash  
Wichita, Kansas 67214  
p. 316.262.1230 f. 316.262.4848  
www.commercialmechanical.net

March 30, 2017

Haysville Schools USD 261  
1745 Grande Ave Haysville  
Haysville, Ks 67060

**Re:** Proposal – Nelson Elementary  
245 North Delos  
Haysville, KS  
Install (1) US Cooler combination walk in refrigeration box

Attention: B J Knudson

Thank you for giving Commercial Mechanical Inc. the opportunity to present this proposal. We will provide supervision labor and equipment as needed to remove and replace the existing walk in cooler \ freezer box.

**Included in this price:**

- Remove and dispose of the old box and refrigeration equipment per EPA regulations
- Install (1) new US Cooler/Freezer walk in box with Russell refrigeration equipment sized to match the existing unit
- New line sets
- Condensate piping with heater
- Electrical service with new disconnects at the condensing units
- The box is equipped with independent lights with switch for each walk in compartment
- Interior Cooler ramp will allow the removal of the existing curb
- Exterior roofing as needed to tie into the existing building
- Start up and check system per the manufactures recommendations
- Warranty terms: 5 year compressor, 1 year parts, 90 day labor

**Total net price.....\$46,000.00**

**Note:** Price is good for 30 days from date of proposal.

**Specifically not included:**

- Dynamic Controls integration if needed
- Overtime labor if required
- Bonding
- Kansas Sales Tax

If you have any questions please call anytime.

Respectfully,  
Commercial Mechanical, Inc.

Blaine Tharp  
Vice President – Service Group  
[Tharpb@commec.com](mailto:Tharpb@commec.com)  
M 316-712-1521

Accepted by: \_\_\_\_\_

Date: \_\_\_\_\_

Ryan Nelson  
Project Manager  
[Nelsonr@commec.com](mailto:Nelsonr@commec.com)  
M 316-304-5606

- 1 Rain roof, single membrane polyester polyvinyl chloride roof system with connectors & drip cap for door. White Material. (use 643) Actual length: 20'-0" Actual width: 15'-6"; Butted Width TermBar:80 Plate:46 Screw:206 Caulk:8
- 1 Sloped foam barrier slipsheet  
4 mil 10' x 100' roll poly
- 1 Sloped foam 1/4" start; 1/4" slope per foot
- 1 Walk-In Combination: 13ft. 0in. X 14ft. 0in. X 8ft. 3in. - *7'7" HIGH INSIDE DIMENSIONS*  
1 Cooler(s) 1 Freezer(s)
- 1 Walk-In Freezer: 6'-10" X 14'-0" X 8'-3" - 4" extruded polystyrene, stucco embossed galvalume 26 gauge exterior, stucco embossed galvalume 26 gauge interior, nsf approved.
- 1 Floor: 6ft. 10in. X 14ft. 0in. - extruded insulation, wood reinforced, 22 gauge stainless steel interior, stucco embossed galvalume 26 gauge exterior  
U.S. Cooler floors are not designed for the use of Forklifts, Pallet Jacks, or Hard Wheeled Carts. Damage caused by this usage will void the panel warranty.
- 1 Door, 30 in. X 76 in.; low temp outside, with floor, threshold, light, switch, heater wire, thermometer, door closure, flush mount, spring loaded hinge, drip cap and screws., hinge left centered on right width wall, with U.S. Cooler Logo
- 1 Pressure relief (use 8644) installed
- 1 Walk-In Cooler: 11'-2" X 14'-0" X 8'-3" - 4" extruded polystyrene, stucco embossed galvalume 26 gauge exterior, stucco embossed galvalume 26 gauge interior, nsf approved.
- 1 Floor: 11ft. 2in. X 14ft. 0in. - extruded insulation, wood reinforced, 22 gauge stainless steel interior, stucco embossed galvalume 26 gauge exterior  
U.S. Cooler floors are not designed for the use of Forklifts, Pallet Jacks, or Hard Wheeled Carts. Damage caused by this usage will void the panel warranty.
- 1 Door, 30 in. X 76 in.; med temp outside with floor, threshold, light, switch, thermometer, door closure, flush mount, spring loaded hinge, drip cap and screws., hinge left centered on right width wall, with U.S. Cooler Logo
- 1 30" x 27" interior ramp
- 1 Test assembly, packaging, and handling - 3'4" x 6'6" vertical  
skid 8 - 57" uprights & 2 - 40" bottom boards
- 1 Test assembly, packaging, and handling - 3'4" x 14' vertical  
skid 12 - 57" uprights & 4 - 40" bottom boards. Includes 2 pieces of full wrap fiber corners.

Nelson Elementary - Wayson Hall

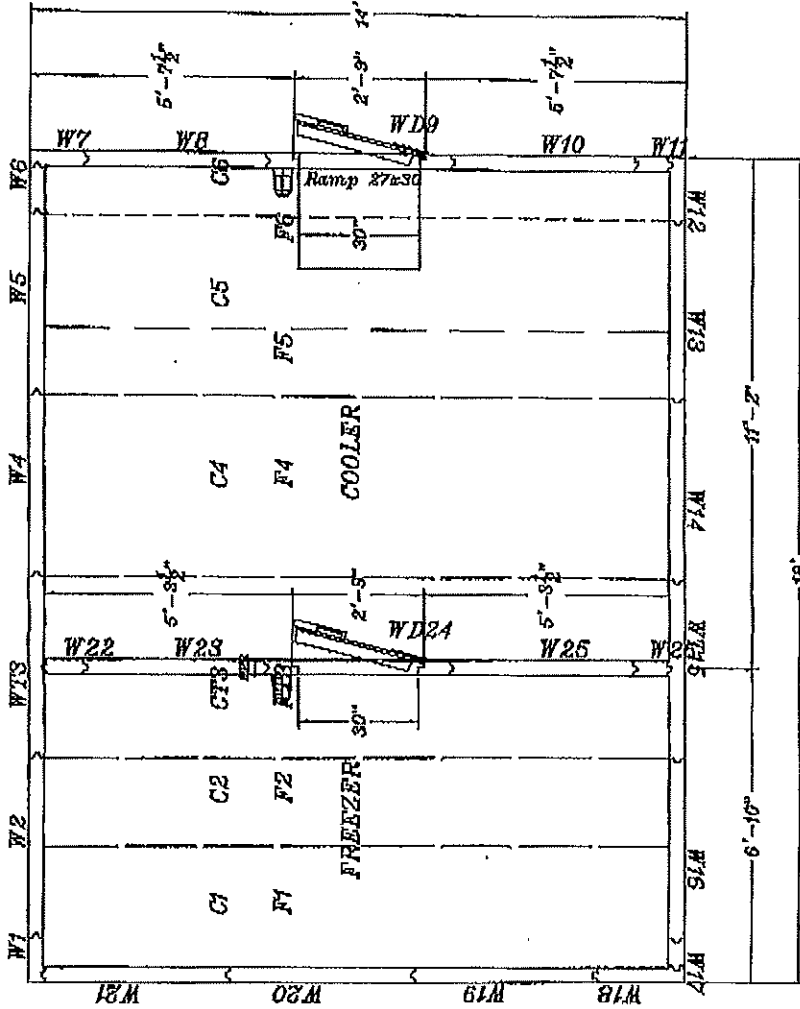
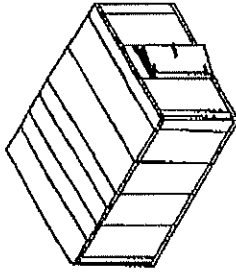

Materials:  
Ext Metal: Galvalume  
Int Metal: Galvalume  
Foam: Extruded  
FREEZER: 6'-10" x 14'-0" x 8'-3" outside  
COOLER: 11'-2" x 14'-0" x 8'-3"  
COMBO: 18'-0" x 14'-0" x 8'-3"  
1/4" = 1'

7'7" inside



LICENSE: 2109, 2108

To: Nelson Elementary; Haysville

From: Mike Strelow

Phone: Cellular: 761-8483 (Freddy)

Pages: 1 of 1

Fax:

Date: 4-6-2017

Re: Walk-in Cooler/Freezer – Option III

C.C. Freddy@usd261

## SCOPE OF WORK

1. Remove existing condenser & evaporator equipment, roof/wall panels, and evacuate line set.
  - a. Per EPA regulations.
2. Furnish and install dual temp walk in cooler/freezer combo; 18'x14'x7'-8".
  - a. Walk-in cooler size: 11'-2" x 14' x 7'-8"
    - i. Wall panels: extruded polystyrene, stucco embossed, 26 gauge galvalume ext./int. nsf approved.
    - ii. Floor: 11'-2" x 14' extruded insulation, wood reinforced, 22 gauge stainless steel interior, stucco embossed galvalume 26 gauge interior, nsf approved.
    - iii. Door: 30" x 76" door; low temp outside, w/ threshold, light switch, heater wire, thermometer, door closure, flush mount, spring loaded hinge drip cap, hinged left center on right width wall, US Cooler logo.
    - iv. 30" x 27" interior ramp.
  - b. Walk-in freezer size: 6'-10" x 14' x 7'-8"
    - i. Wall panels: extruded polystyrene, stucco embossed, 26 gauge galvalume ext./int. nsf approved.
    - ii. Floor: 6'-10" x 14' extruded insulation, wood reinforced, 22 gauge stainless steel interior, stucco embossed galvalume 26 gauge interior, nsf approved.
    - iii. Door: 30" x 76" door; low temp outside, w/ threshold, light switch, heater wire, thermometer, door closure, flush mount, spring loaded hinge drip cap, hinged left center on right width wall, US Cooler logo.
    - iv. Pressure Relief
  - c. Russell refrigeration equipment
  - d. New line sets, condensate piping w/ heater,
3. Furnish and install solenoids, controllers, refrigerant, pressure relief, line sets, condensate, etc.
4. Furnish and install roofing membrane; per owner's specifications.
5. Furnish and install ramp.
6. Provide 5-year warranty on compressor, 1-year warranty on parts, 90-day labor warranty.

300 CAIN DRIVE

P: 316-529-4372 HAYSVILLE, KS. 67060 F: 316-529-4395

[3rmechanical@3rmechanical.com](mailto:3rmechanical@3rmechanical.com)

Page 1 of 2

- 7. Replace electrical conduit and wire, terminate, and check. Re-use existing breakers & roof blocks.

**TOTAL W I C Equipment Package: \$53,701.95**  
**ADD FOR BOND IF REQUIRED: 1.50%**

**THIS QUOTE IS GOOD FOR 30 DAYS**

**STANDARD NOTES AND EXCLUSIONS – (ITEMS ABOVE TAKE PRECEDENCE)**

---

No cut, patch, removal, replacing, or drilling of concrete, masonry, or asphalt paving.  
No sales tax or permits.

Thank you for the opportunity to quote this project. If you have any questions, please do not hesitate to contact us. If this proposal is acceptable, please sign and return.

SINCERELY,



MIKE STRELOW

\_\_\_\_\_  
Acceptance signature

\_\_\_\_\_  
Date



---

3636 N. TOPEKA • WICHITA, KS 67219  
(316) 838-7885 • FAX (316) 832-2876  
WWW.KRUSECORP.COM

---

## SERVICE ESTIMATE

Date: April 14, 2017  
To: B.J. Knudson  
Fax / Email: 316-554-2212 / bknudson@usd261.com  
Organization: Haysville USD 261  
Service Location: 245 Delos Haysville KS 67060  
Scope: Removal and installation of walk in freezer and cooler

### Items Included:

- Parts and labor to remove existing cooler and freezer
- Removal of existing spoils from sight
- Parts and labor for the installation of US cooler walk in cooler and freezer
- Installation of 2= Russel condensers with new refrigerant piping
- Condensate piping and heater for freezer
- Tie new cooler into existing building and make rain tight
- Line voltage and control voltage and new disconnects for the new condensers
- Installation of independent light switches for each compartment
- Provide 5 year compressor warranty, 1 Year parts and labor warranty
- Start-up, verify operational safeties, and tune per manufacturer specs.

Total Service Price \$ 64,088.00 + Applicable Sales Tax

### Items Excluded:

- Sales tax

Kruse Corporation appreciates the opportunity to bid this project. If you have any questions please do not hesitate to call (316) 838-7885. Please note this quote is only good for 30 days from issue. To accept the above bid please sign and date below and return to us at fax number 316-832-2876 or awright@krusecorp.com.

Respectfully submitted,  
Al Wright  
Service Manager

ACCEPTED BY:

Signed: \_\_\_\_\_

Date: \_\_\_\_\_

**"BIG ENOUGH TO DO ANY JOB, SMALL ENOUGH TO CARE THAT IT IS DONE RIGHT."**